



RHINO-RACK

Hyundai Tucson - Gen 3 Pre facelift: TL, TLE, TL2, TLE2 - SX047

Fit Time: 40min

Note: Pre-facelift model shown. Ensure vehicle tail-lights match image displayed.

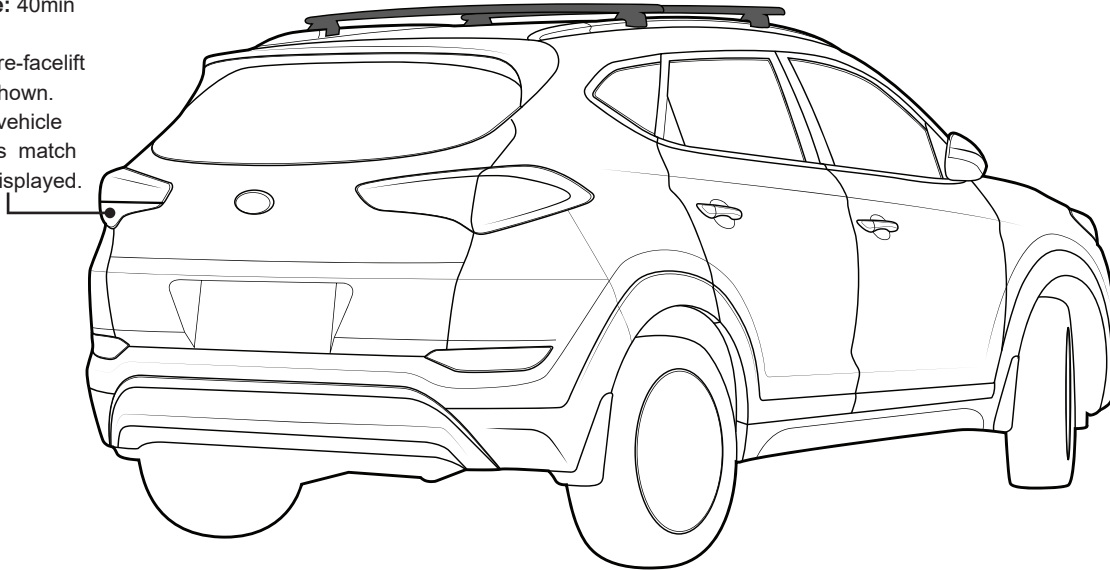

Important Information

Maximum carrying capacity:

On Road Cargo Allowance	Off Road Cargo Allowance	Roof Allowance	Rack Weight
75kg / 165lb	50kg / 110lbs	80kg / 176lbs	5kg / 11lb

Off Road: Any driven path taken that is not on sealed (tarred / bitumen) and maintained

Roof Allowance: Total permissible weight attached to the roof of the car. This is inclusive of the weight of the roof rack system

Cargo Allowance: Total permissible weight allowed on top, and attached to roof racks whilst the vehicle is in motion

Static Allowance: Total permissible weight allowed on top, and attached to roof racks whilst the vehicle is stationary

Please refer to your vehicle manufacturers handbook for maximum carrying capacity. Always use the lower of the two figures. Load must be evenly distributed over the two racks. Weight of roof rack accessories is to be included in cargo allowance.

Torque settings

Unless stated otherwise in these instructions, all fasteners should be set to the following torque settings - M6: 4-5Nm (3-4lbs/ft), M8: 8-10Nm (6-7.5lbs/ft) and M10: 16-18Nm (12-13lbs/ft).

Warning:

- Check Part No. and/ or Kit is correct for use with your vehicle
- Do not attempt to fit the rack system to your vehicle unless you fully understand these fitting instructions. Please direct any questions regarding fitting to the dealer from where the roof racks were purchased.
- **Use only non-stretch fastening ropes or straps.**
- The handling characteristics of the vehicle changes when you transport a load on the roof. For safety reasons we recommend you exercise extreme care when transporting wind-resistant loads. Special consideration must be taken into account when cornering and braking.
- Although the system is tested and approved to AS1235-2000 / ISO 11154, off-road conditions can be much more rigorous. Extreme care must be taken in off road conditions.
- Roof racks must be removed when vehicle is put through an automatic car wash.

Recommendations:

It is essential that all bolt connections be checked after driving a short distance when you first install your roof racks. Bolt connections should be checked again at regular intervals (once a week is enough, depending on road conditions, usage, loads and distances travelled). You should also check the roof racks each time they are re-fitted. Always make sure to fasten your load securely. Please also ensure that all loads are evenly distributed and that the centre of gravity is kept as low as possible and must be entirely contained within the extents of the roof racks.

Note for Dealers and Fitters:

It is your responsibility to ensure these fitting instructions are given to the end user or client

Rhino-Rack, 22 Hanson Pl, Eastern Creek
NSW 2766, Australia
(02) 8846 1900
rhinorack.com.au

Document No: R1452
Issue No: 03
Issue Date: 02/04/2019

These instructions remain the property of Rhino-Rack Australia Pty. Ltd. and may not be used or changed for any other purpose than intended.

Hyundai Tucson - Gen 3 Pre facelift: TL, TLE, TL2, TLE2 - SX047

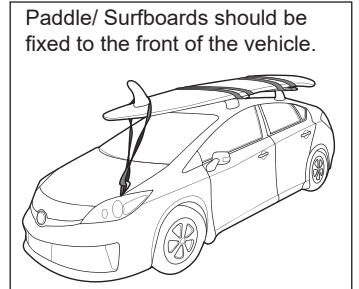
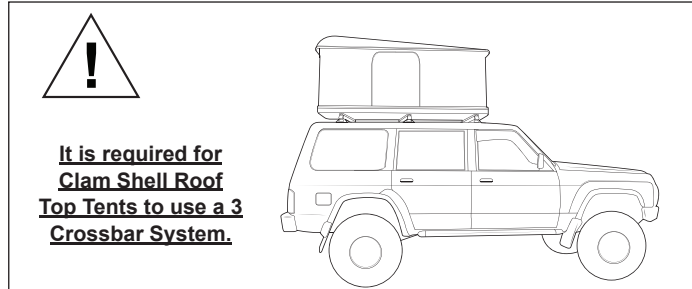
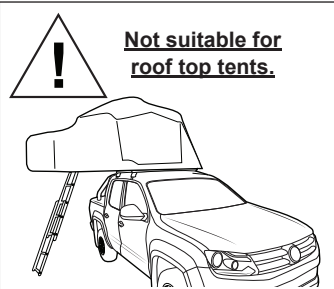
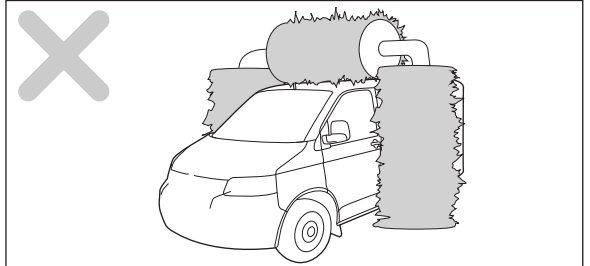
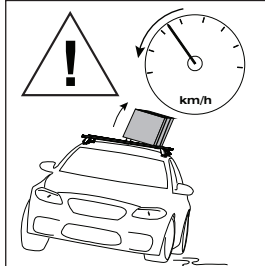
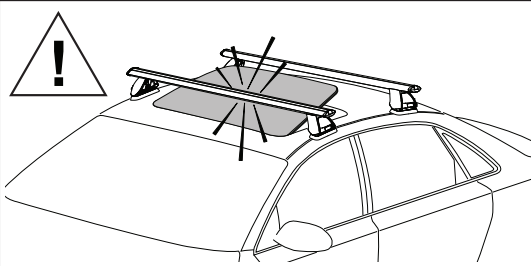
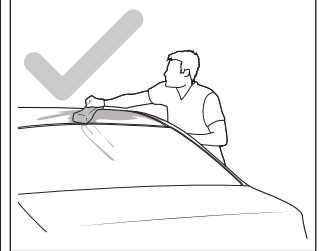
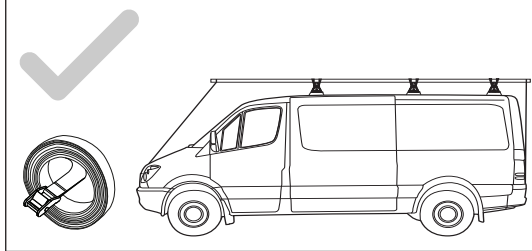
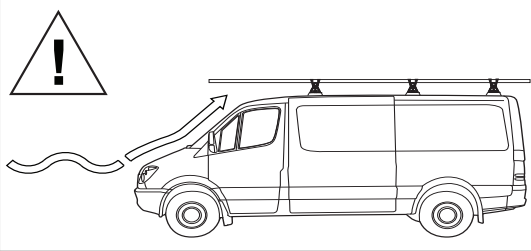

WARNING! Important Load Carrying Instructions
 With utility vehicles, the cabin and the canopy move independently. Roof racks and vehicle can be damaged if the item transported is rigidly fixed at points on both the cabin and canopy. Instead, rigidly fix to either the cabin roof racks or the canopy roof racks.

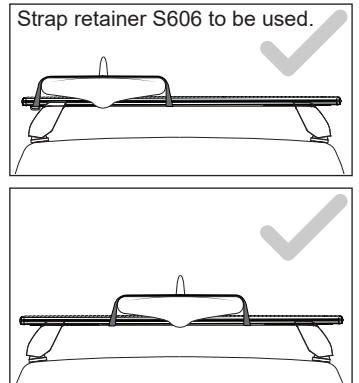
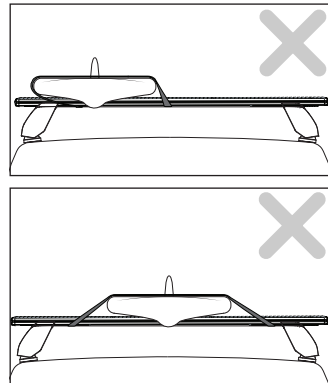

Kayaks should use additional straps to secure the load at the front and rear of the vehicle where possible. Always use Kayak Carrier Cradles when transporting Kayaks on the roof.

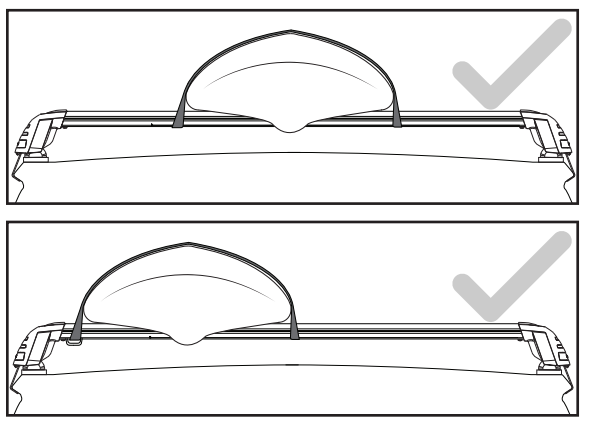
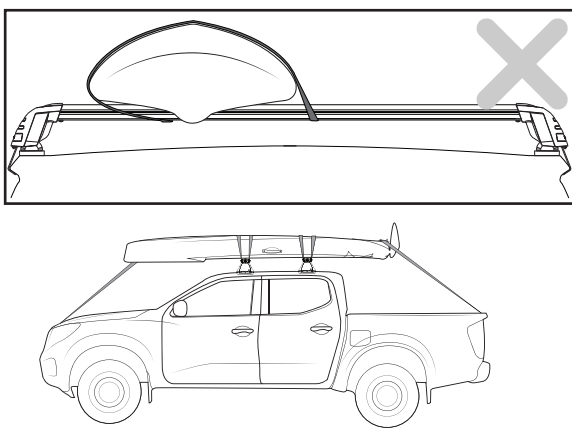

Optimal Setup:
 The Kayak should be housed in Cradles and held in place with tension straps. The front and rear of the Kayak should be fixed to the front and rear of the vehicle. A Nose Tie Down (RBAS1) should be used to secure the front of the Kayak.

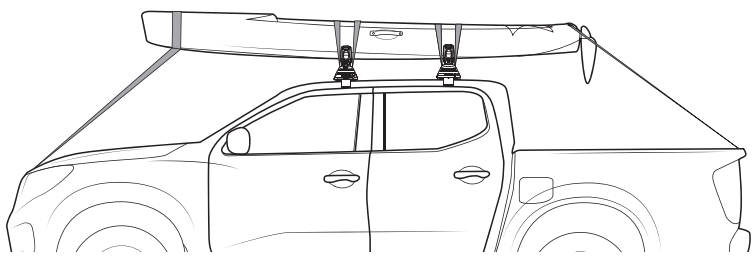

Hyundai Tucson - Gen 3 Pre facelift: TL, TLE, TL2, TLE2 - SX047

Parts Required



Crossbars
(VA126S, VA126B Sold as separate)

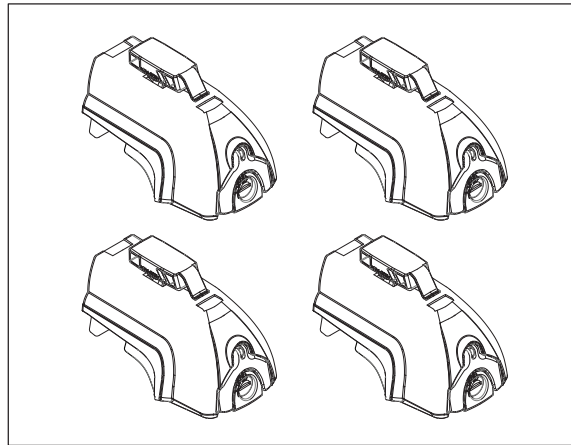

Leg Kit

Parts List

Item	Component Name	Qty	Part No.
1	Leg Unit	4	CA1600
2	Rubber Insert	4	M821
3	Clamp Assembly	4	CA1563
4	Rubber Boot	4	M816
5	Outer Clamp	4	CA1584
6	Dowel Nut	4	-
7	Adjustment Rod	4	SP222
8	Metal Key	2	-
9	Instructions	1	R1452

Tools Required:

Tape measure.
Scissors. Knife.

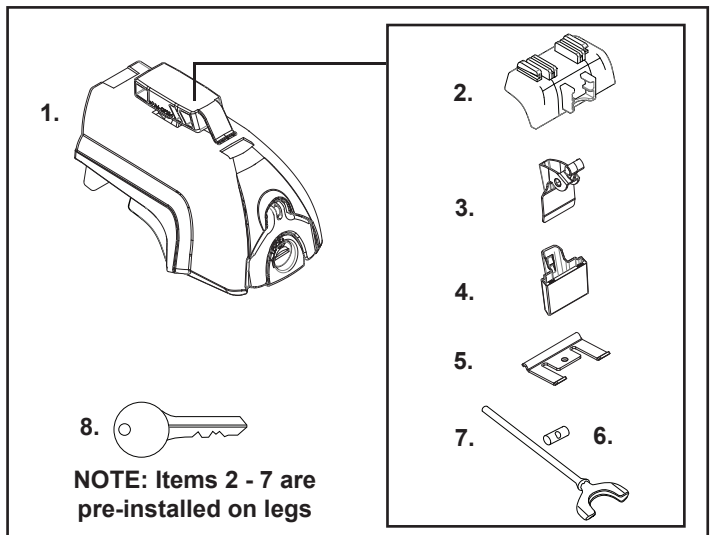

Instructions

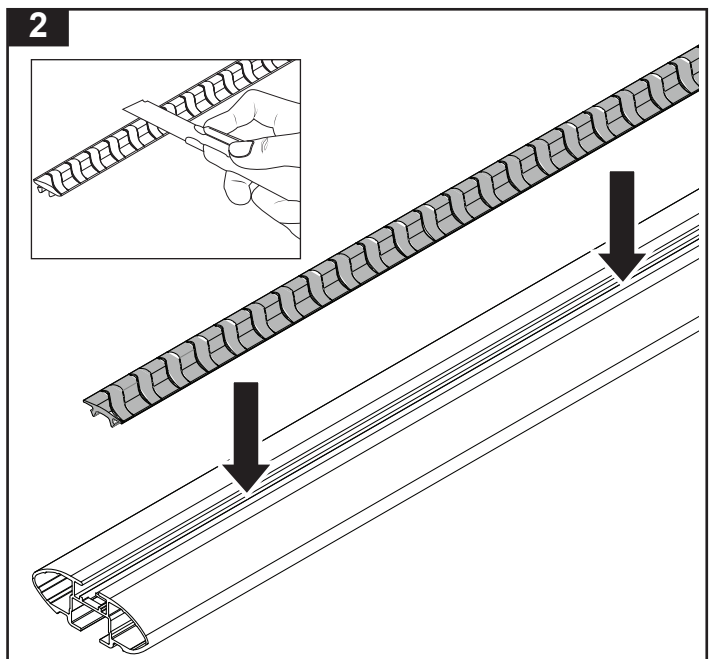
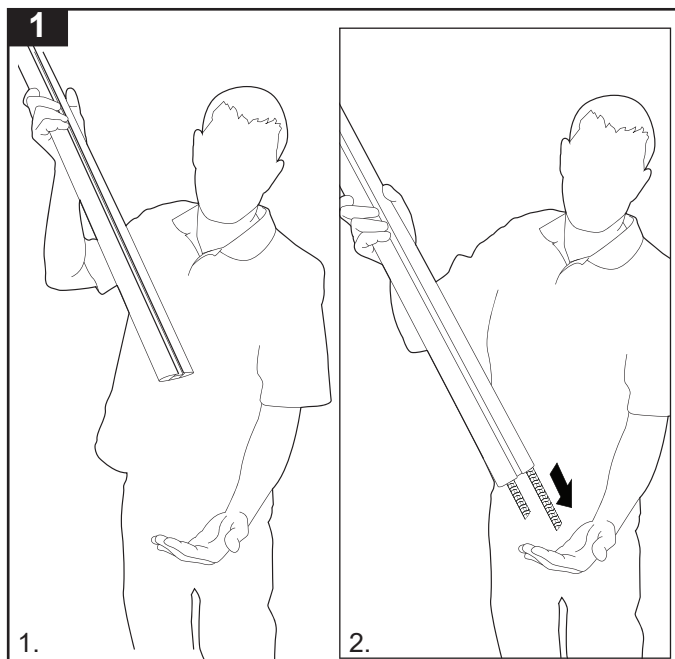

Hyundai Tucson - Gen 3 Pre facelift: TL, TLE, TL2, TLE2 - SX047

3

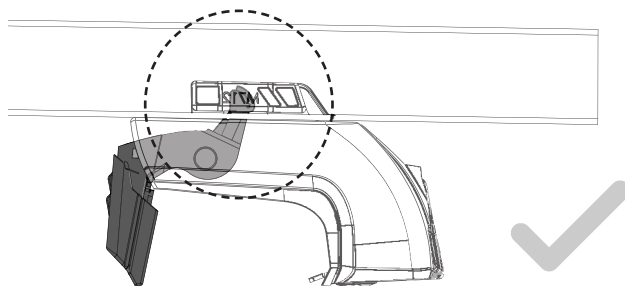
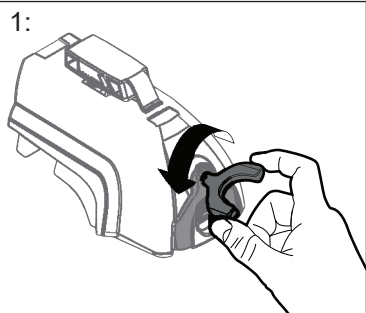

2:

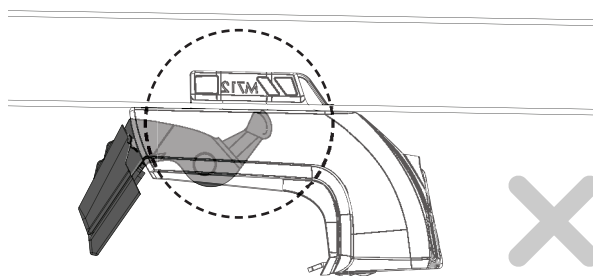
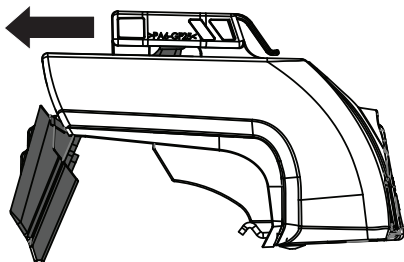
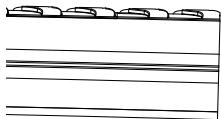

4a

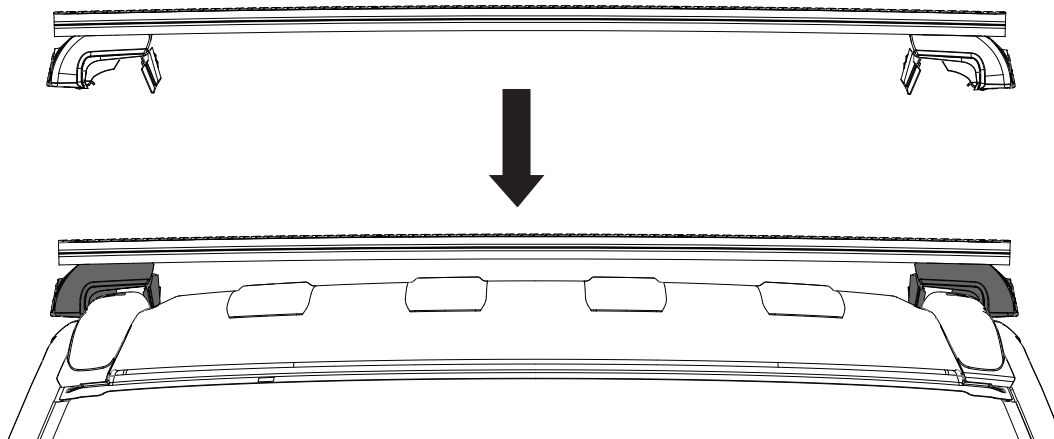

4b

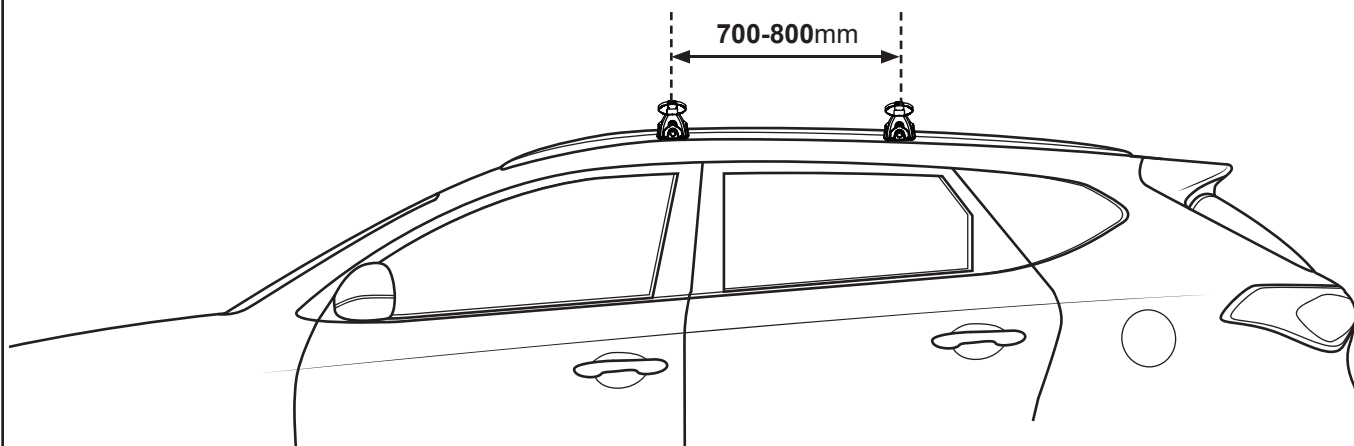

Hyundai Tucson - Gen 3 Pre facelift: TL, TLE, TL2, TLE2 - SX047

4c

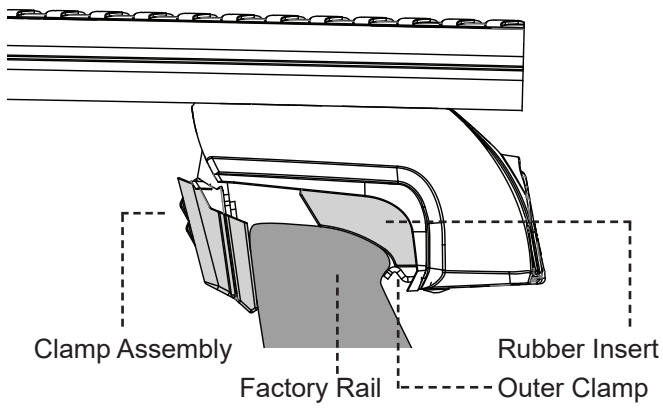

5

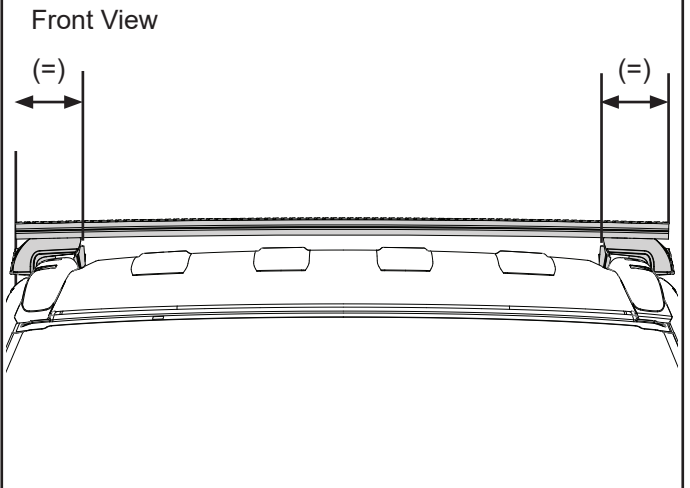

6

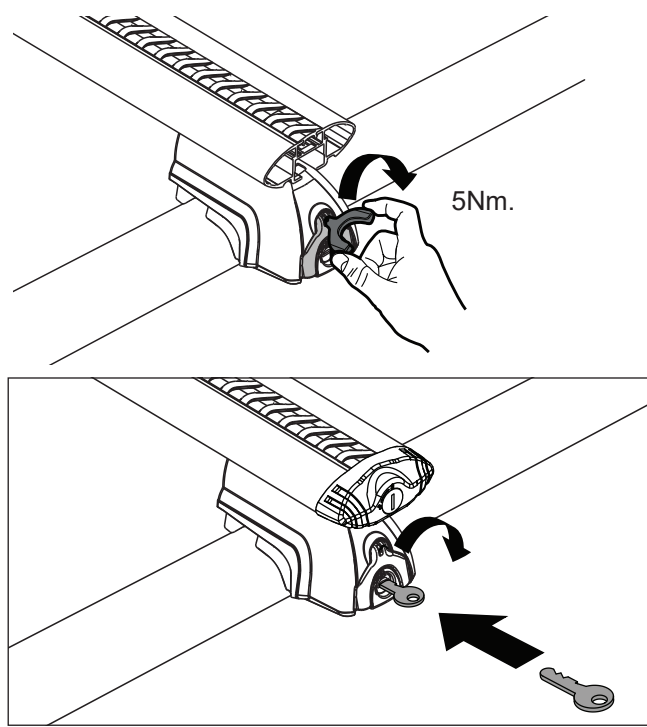

7

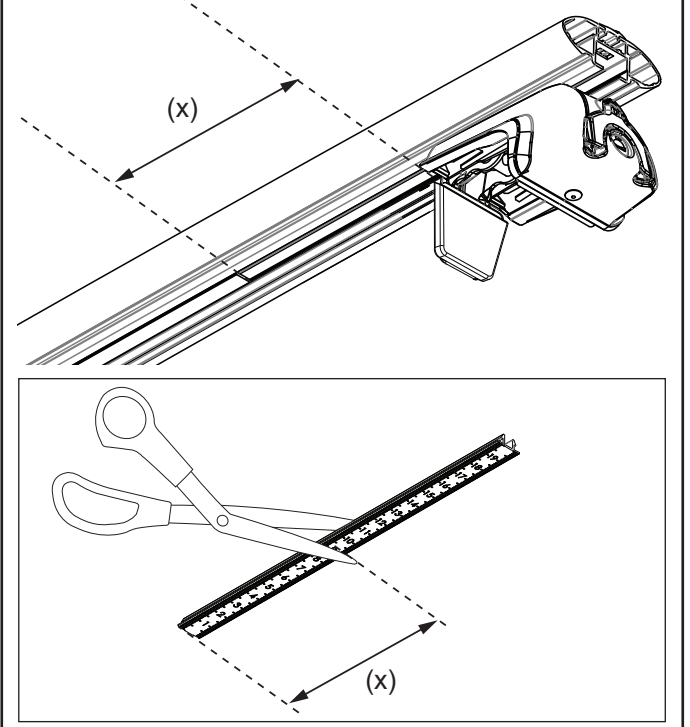

8

1:

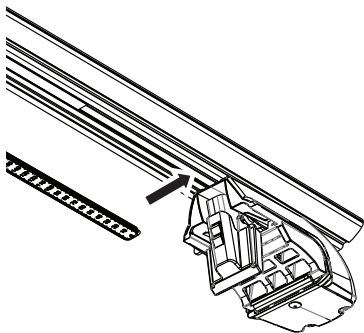

2:

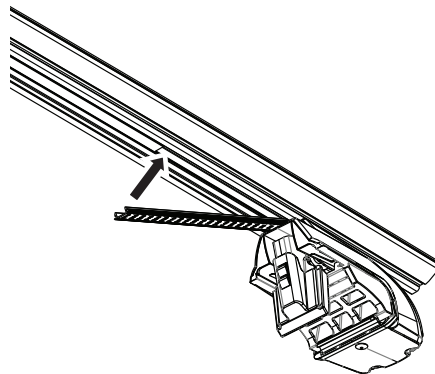

3:

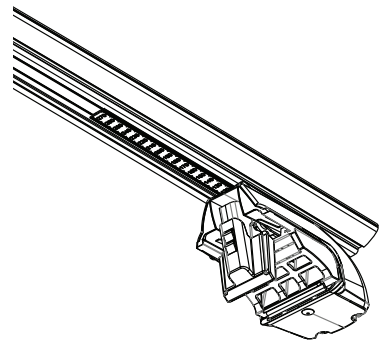

Hyundai Tucson - Gen 3 Pre facelift: TL, TLE, TL2, TLE2 - SX047

